

SET UP BASIC PARENTAL CONTROLS

- Tap the “+” icon from the main menu.
- Select “People” to create a new profile.
- Add a name and photo if desired.
- Select the devices which belong to this profile.
- Select “Done”.
- From the home screen, Select “People” and select the desired profile.
- Swipe the Internet Access toggle off to pause all devices connected to the profile. Toggle on to bring devices back online.
- Set time limit schedules to turn Internet access off for all assigned devices during specific times and days.

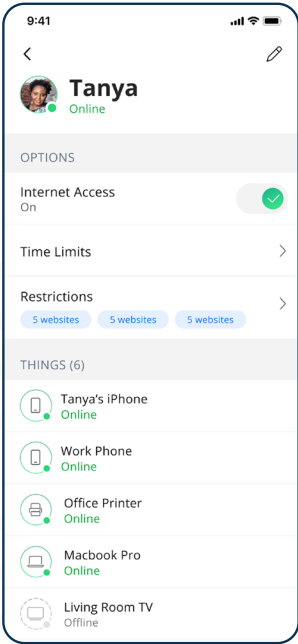

UPDATE WIFI NETWORK NAME AND PASSWORD

- Press “My Network” on the Home screen.
- Press “Networks”.
- Select the network you wish to update the name or password for.
- Press “Edit” and update your information.

Note: changing your SSID or password will require you to reconnect all your wireless devices previously connected to that network.

RUN A SPEED TEST

- Select “My Network” from the Home screen.
- Select your main router.
- Select “Bandwidth Test”.
- Select “Run Test”.

The speed test will first run between the GigaSpire BLAST and the Internet and then will conduct a speed test between any mesh units and the GigaSpire BLAST. Results will show as a notification in the app and update on the screen.

VIEW DEVICES ON YOUR NETWORK

- Select “Things” from the Home screen.

NOTIFICATIONS

View notifications from the Home screen by selecting the bell icon in the top right.

To edit notifications settings, go to Settings and Notifications.

EXPERIENCEIQ

This powerful feature lets you manage screen time, content and access to website, and applications, all from the app.

It also lets you prioritize which devices should get preferred connection so if you work from home and want to make sure you always have enough bandwidth, this feature is for you.

PROTECTIQ

As hackers become increasingly sophisticated, your network requires an equally innovative solution.

ProtectIQ keeps a lock on your network and alerts you when unwanted visitors, hackers, viruses, or malware try to visit. If it’s connected, it’s protected!

UPGRADE TODAY!

- ExperienceIQ - \$4.99
- ProtectIQ - \$4.99
- ExperienceIQ and ProtectIQ - \$7.98

Learn more at goctc.com/wifi!



CTC COMPLETE WIFI Quick Start Guide

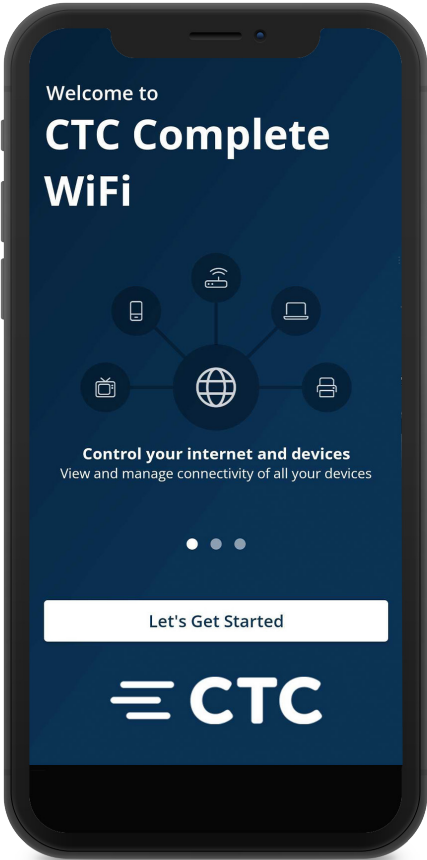

GET STARTED WITH THE APP!

1 Download the app. You can search either the Apple App Store or Google Play Store for CTC Complete WiFi, then install it on your mobile device.



2 Select “Let’s Get Started” towards the bottom of the screen.

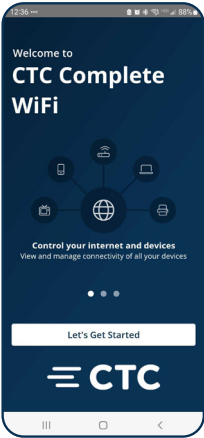

3 Select ‘Sign Up’ towards the bottom of the screen. Enter your personal information. The password you enter here will be used to access the app.

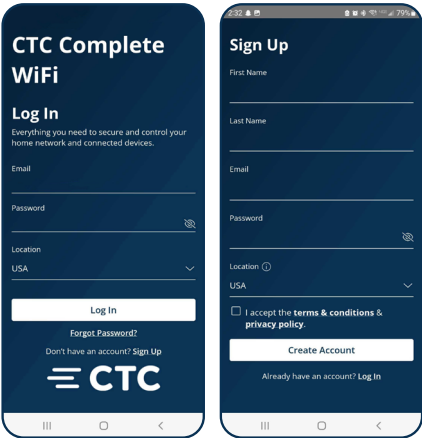

4 Select ‘Start Set Up’ to set up your new router, then select your router model. CTC currently uses models: u6.1 GS4220E and u4 GS2028E

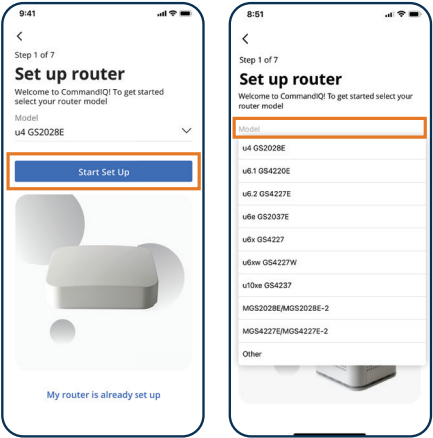

Note: Your router name or number can be found at the bottom of the system.

5 Follow the next steps for new router set up.

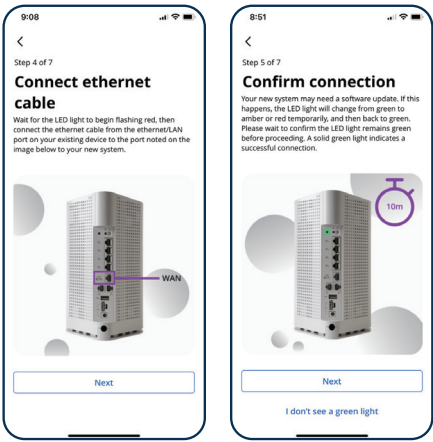
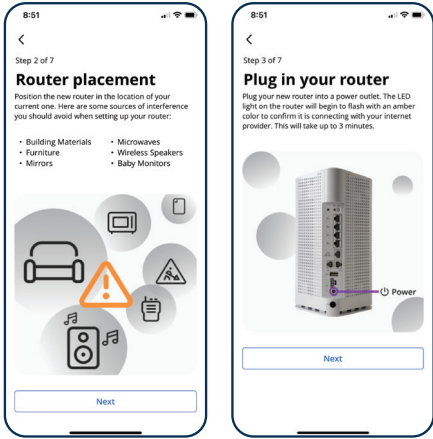

6 Now that your new router is set up, you can set up your WiFi network.

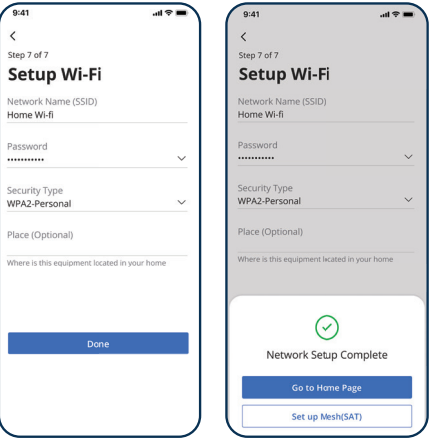

CREATE A GUEST NETWORK

- Tap the “+” icon from the main menu.
- Select Networks.
- Select “Guest” in the drop-down menu.
- Give your Guest Network a name (SSID) which will be visible to guests.
- Select security type, if desired.
- Choose a password.
- Select isolation if you do not want the user to be able to access your other wireless networks.
- Set the duration to endless or create a custom duration.

